

Dimensions (inches)

Pump Model	A	B	C	D
80557	37.87	32.80	38.11	74.25

For connection sizes/ratings and motor sizes refer to engineering data table on reverse.

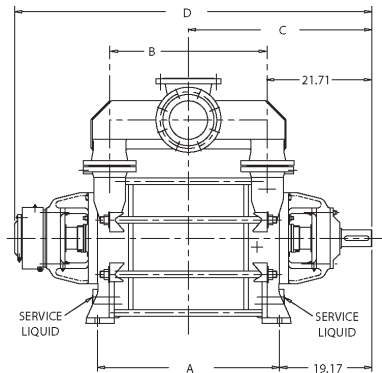
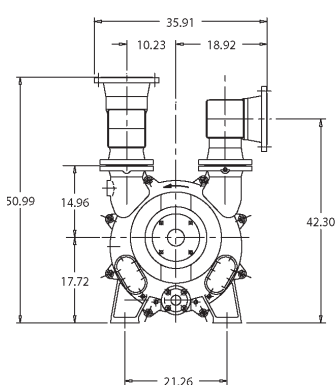

For baseplate mounting, please obtain factory certified dimensions.

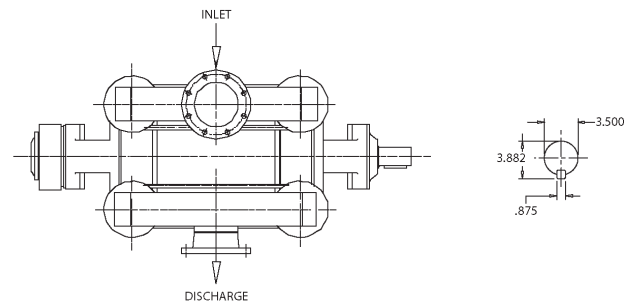

Capacity Table

Pump Model - LPH 80557																
Speed (RPM)	4" Hg. 658 Torr		8" Hg. 557 Torr		12" Hg. 455 Torr		16" Hg. 354 Torr		20" Hg. 252 Torr		24" Hg. 150 Torr		26" Hg. 100 Torr		26.4" Hg. 89 Torr	
	acfm	HP	acfm	HP	acfm	HP	acfm	HP	acfm	HP	acfm	HP	acfm	HP	acfm	HP
735	2130	74	2125	88	2115	96	2080	102	2015	106	1880	106	1580	106	1440	106
680	1960	63	1950	78	1935	85	1890	90	1820	94	1700	95	1410	96	1140	96
575	1610	47	1610	58	1600	66	1560	70	1500	73	1350	74	1100	75	950	75

This data represents average values for pumps in standard materials. Capacity in cubic feet per minute at 68°F (20°C) using 60°F (16°C) water as a service liquid. Vacuum in inches Hg. Barometric pressure at sea level 29.92" Hg. abs. (760 Torr).

All performance data per HEI standards; subject to SIHI standard tolerances.

ENGINEERING DATA

PUMP MODEL	80557
Gas Conn. Size/Rating (U)	8" / 150 RF
Service Liq. Line Size/Rating (U <sub>B</sub> )	2" / NPT
Cont. Drain Size/Rating (U <sub>se</sub> )	1/2" / NPT
4 Motor (@ 1750 rpm) HP	125
Bare Pump Wt. (lb)	3050
4 V-Belt Dr. Basemount (lb)	5808
Min. V-Belt Sheave Dia.	11.02"
Separator Model - WSDA	8"
Separator Size - Recirc. (Gal.)	140
1/2 Norm. Max. Gas Temp. (°F)	176
2 Max. Service Liq. Temp. (°F)	140
3 Sound Level @ 24" HgV (dBA)	80
Moment of Inertia Wr <sup>2</sup> (lb. ft <sup>2</sup> )	249.2
Casing Max. Working Pressure (psi)	30
Pneumatic Test Pressure (psig)	15

1. Max. gas temperature with saturated gases.
2. Higher temperatures possible on request.
3. At 3 ft., 735 RPM w/o motor (not certified).
4. Basemount includes pump, motor, base, belt drive, belt guard, and motor slide base. Based on 735 RPM pump speed, and TEFC motor with 1800 RPM synchronous speed.

SERVICE LIQUID RATES (USGPM)

PUMP MODEL-LPH 80557															
Pump Speed	8" Hg. 557 Torr			12" Hg. 455 Torr			16" Hg. 354 Torr			20" Hg. 252 Torr			26.4" Hg. 100 Torr		
	A	B	C	A	B	C	A	B	C	A	B	C	A	B	C
735		13.0	10.5		16.0	13.0		17.0	13.0		21.0	15.5		22.5	16.5
680	17	12.0	9.5	22	15.0	12.0	24	16.5	12.0	31.5	20.0	14.5	36	21.5	15.5
575		11.5	8.5		14.5	11.5		14.5	11.0		18.0	13.0		19.0	13.0

Column 'A' is the flow in USGPM required - once through.  
 Column 'B' is the make-up flow required when make-up water is 5°C (9°F) cooler than service water.  
 Column 'C' is the make-up flow when make-up water is 10°C (18°F) cooler than service water.

**Note:** The service liquid supply pressure may vary with pump speed and vacuum level. Please consult factory engineering department for additional information.

SECTIONAL

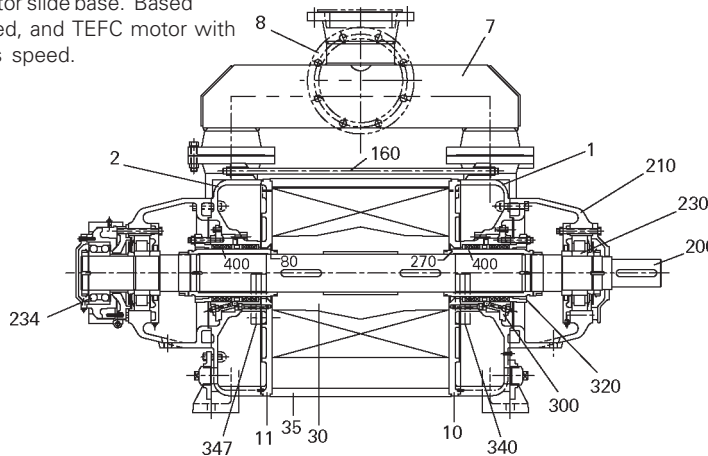

Standard rotation 'AB' (clockwise) viewed from driven end. 'AL' (counter clockwise) upon request.

PARTS LIST

- |                       |                        |                             |                             |
|-----------------------|------------------------|-----------------------------|-----------------------------|
| 1. Suction Cover      | 30. Impeller           | 230. Bearing                | 347. Orifice Plate Assembly |
| 2. Discharge Cover    | 35. Centerbody         | 234. Bearing                | 400. Packing                |
| 7. Suction Manifold   | 80. O-Ring             | 270. Shaft Sleeve           | 404. Lantern Ring           |
| 8. Discharge Manifold | 160. Tie Bolt Assembly | 300. Stuffing Box Flange    |                             |
| 10. Intermediate      | 200. Shaft             | 320. Gland                  |                             |
| 11. Intermediate      | 210. Bearing Housing   | 340. Orifice Plate Assembly |                             |

MATERIALS

ITEM	0B	4B
Casing-Wetted	Cast Iron	316 SS
Intermediates	Cast Iron	316 SS
Impeller(s)	Ductile iron	316 SS
Centerbody	Steel	316 SS
Shaft <sup>5</sup>	Steel	Steel
Shaft Sleeves	420 SS	316 SS
Shaft Sealing	041 <sup>6</sup>	ADB <sup>7</sup>
Casing-Non Wetted	Cast Iron	Cast Iron

<sup>5</sup> Shaft is a non-wetted part <sup>6</sup> 041 = Packing (GFO or Equal) with liquid seal from the pump internals <sup>7</sup> ADB = single o-ring pusher seal with viton o-rings, carbon vs. SiC faces